

**Section:** 412-02B

**Model:** Galaxy -with booster heater/parking heater (Build Date: 02/95 - 03/00) (Build Code: SK - YA)  
Galaxy 2000.75-with booster heater/parking heater (Build Date: Up to 26.01.2003 ) (Build Code: Up to 3C )

**Markets:** All

**Subject:** Ticking noises in the passenger compartment when the booster heater is in use

### Summary

Should a customer express concern over ticking noises in the passenger compartment when the booster heater is in use, the probable cause is a transmission of vibrations via the fuel line from the metering pump to the body of the vehicle. To rectify this concern, install a revised fuel line with modified clips between the metering pump and the booster heater.

#### Parts Required

Description	Finis Code
Fuel hose	1 300 950
Fuel line	1 300 951
Foam lining	1 300 953
Clip, fuel line to brake lines(Quantity:2)	1 018 388
Clip (if required)(Quantity:3)	6 991 865
Clamp, retaining(Quantity:3)	1 010 867

#### Labour Time

Install revised fuel line between metering pump and booster heater	(0,6 hours)
--	-------------

#### Repair Code

Causal Part:	Finis Code of the fuel line
Defect Code:	
ACES Condition Code:	43

### Production Action

A revised fuel line has been installed on the metering pump in production since 27.01.2003 (build code 3C).

## Service Instructions

See Summary

### Installing the revised fuel line

1. Raise and support the vehicle. For additional information, refer to Galaxy 100 02.

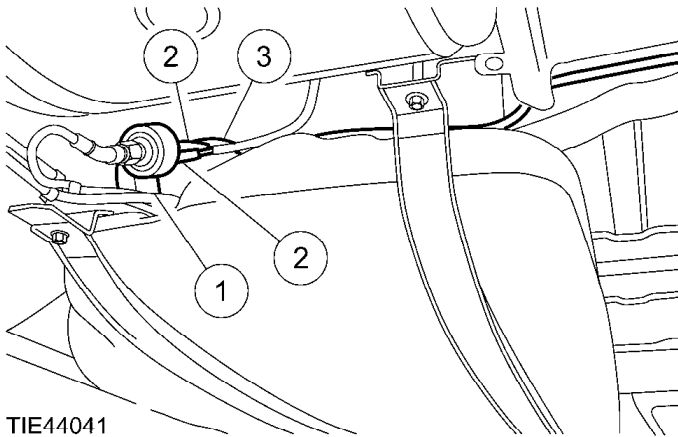

2. Detach the fuel line from the metering pump.
  - 1 Detach the metering pump (one bolt).
  - 2 Disconnect the electrical connector.
  - 3 Disconnect the fuel line from the metering pump (one retaining clamp) and detach the fuel line from the frame.

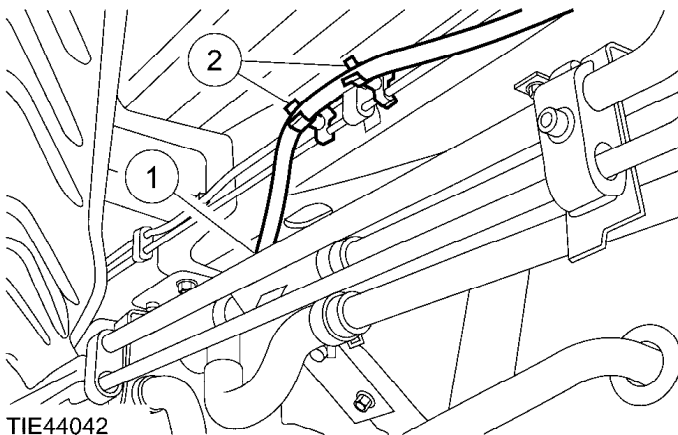

3. Remove and discard the fuel line.
  - 1 Detach the fuel line from the booster heater (one retaining clamp).
  - 2 Remove and discard the fuel line and retaining clips.

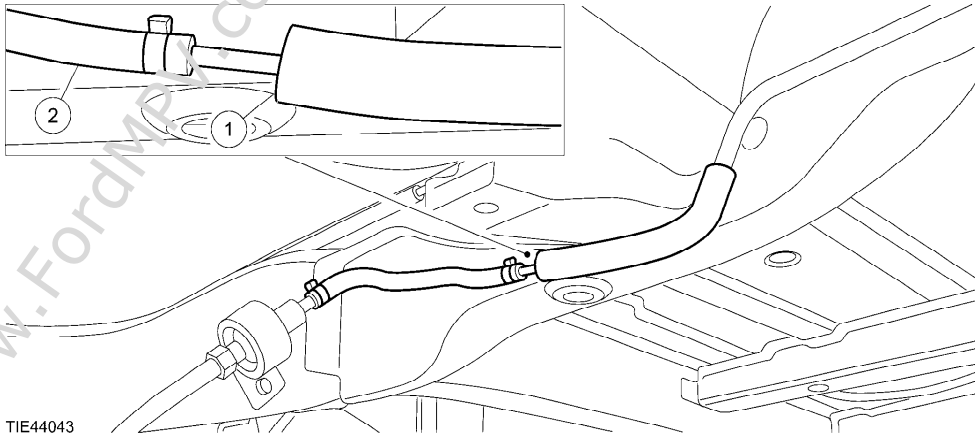

TIE44043

4. Install a new fuel line and a new fuel hose (shown with the fuel tank removed).

**Note:**

The foam lining must end flush with the fuel line.

- 1 Slide the foam lining (see Parts Required) over the fuel line and move the fuel line into installation position.

**Note:**

Make sure the closure on the retaining clamp points upwards in order to prevent contact with the fuel tank.

- 2 Attach a new fuel hose (see Parts Required) to the metering pump and the fuel line using two new retaining clamps (see Parts Required).

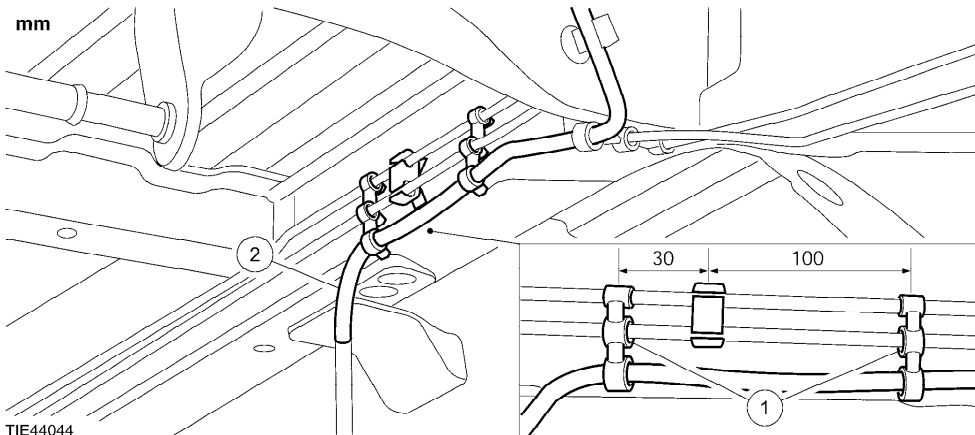

TIE44044

5. Install the fuel line and a new fuel hose (shown with the exhaust system removed).

**Note:**

Installation positions of the clips.

- 1 Attach the fuel line to the brake lines using two new fuel line clips (see Parts Required).  
 2 Attach the fuel line to the booster heater using a new retaining clamp (see Parts Required)
6. Attach the fuel line to the frame, using new clips as required (see Parts Required).
7. To install, reverse the removal procedure.

